

Electromagnetic Lock Installation Instruction (Waterproof Series)

Optional Bracket

Brackets installation are according to door swing direction and door frame type , e.g. narrow frame door , frameless glass door , inswing door , etc.

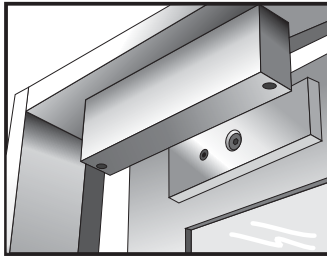

Regular Installation
(outswing door)

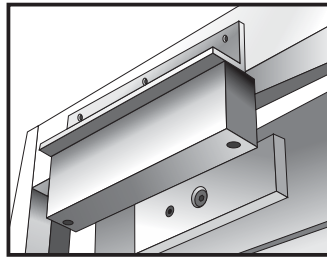

L-bracket for
narrow frames (optional)

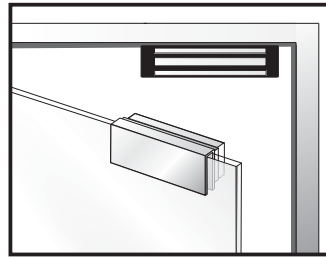

U-bracket for frameless
glass doors (optional)

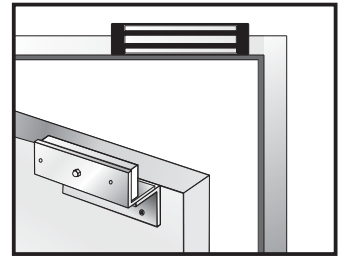

LZ-bracket for
inswing doors (optional)

Regular Installation

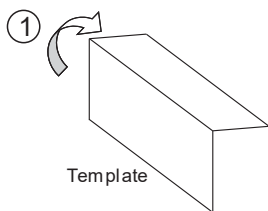

Fold the mounting template 90°

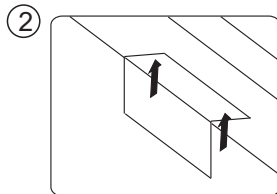

Place the template to the proper position of the door and frame .Mark the hole positions of the template to the door and frame

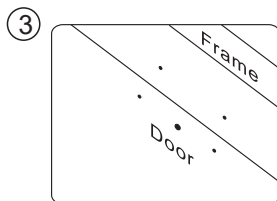

Drill the holes according to the marks.

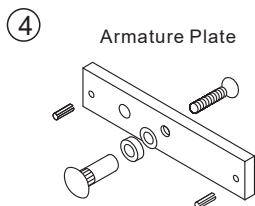

Armature Plate

Please install the armature plate as illustrated here. (Dimensions of the holes are depending on the door types as illustrated below.)

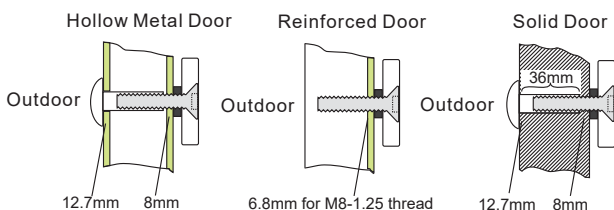

Drill a Ø8mm hole through door, on closing side enlarge to Ø12.7mm by a sexnut blot on the opening side.

Drill a Ø6.8mm hole and tap on closing side a M8x12.5 thread.

Drill a Ø8mm hole through door on closing side enlarge to Ø 12.7mm, by a sexnut blot on the opening side. The depth is 36mm.

Recommendation:

For Micro EM-locks (300 LBS), maximum thickness of door is 44 mm.
For Mini EM-locks (600 LBS), maximum thickness of door is 50 mm.
For Midi EM-locks (800 LBS), maximum thickness of door is 48 mm.
For Maxi EM-locks (1200 LBS), maximum thickness of door is 46 mm.

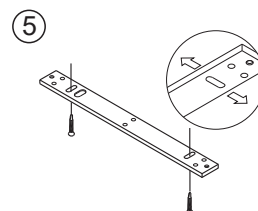

Fasten the mounting plate with the mounting screws. The position of the mounting plate should be adjustable.

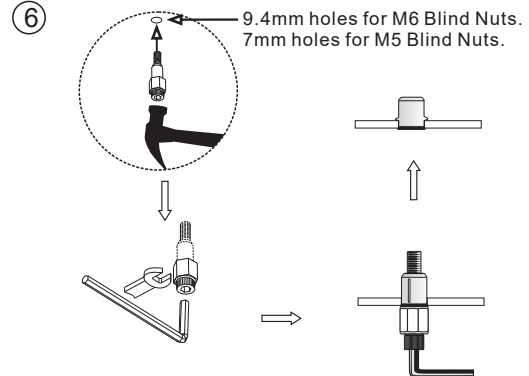

9.4mm holes for M6 Blind Nuts.
7mm holes for M5 Blind Nuts.

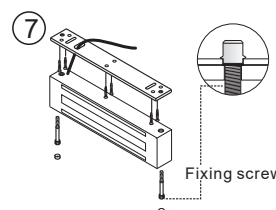

Use the screws to permanently mount the mounting plate, then mount the magnet with the fixing screws provided.

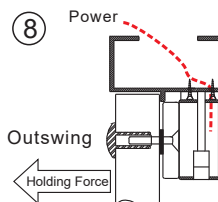

Connect the power and test the unit. Insert the anti-tamper caps into the holes of mounting screws.

Butt Splice(IDC) Connector

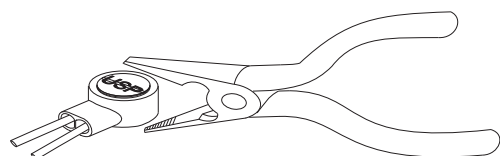

Using crimper or pliers and pressing the header of connector down to even position.

LZ or Z bracket for inswing doors

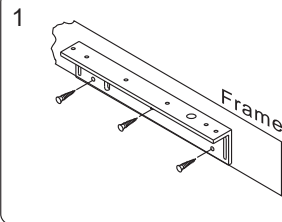

Find a mounting position on the door frame for the L bracket. Make sure that the door is still closeable.

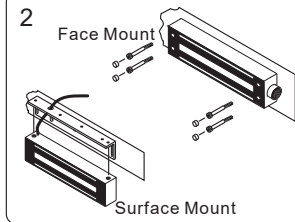

Use the fixing bolts to tighten the electromagnetic lock on L bracket. (For face mount, the magnetic lock can be mounted directly on the door frame).

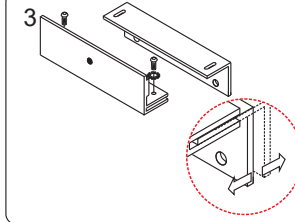

Assemble the Z bracket, and make sure that the Z bracket is adjustable.

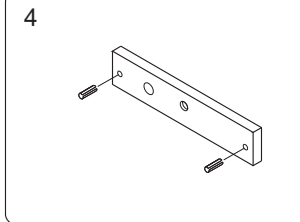

Insert the guide pins into the armature plate.

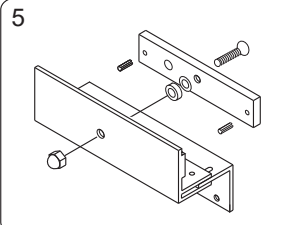

Fasten the armature plate to the Z bracket (Must add rubber washer).

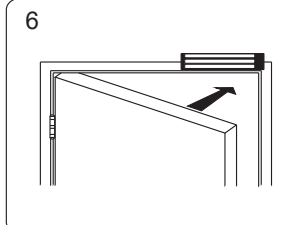

Close the door and connect the power.

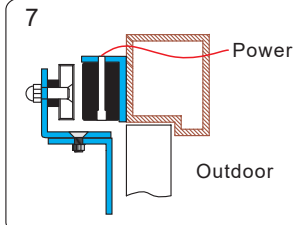

After the maglock attracts the armature adjust plate, the Z bracket to fit the door.

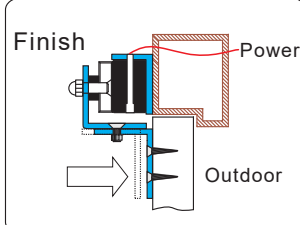

Fasten the Z bracket to the door.

Connecting Diagram

Wire Leads (Power input is polarity free)	Power Input	Bond sensor output	Diagram	Bond sensor output
2 Wire Leads Single voltage (Power input is polarity free)	12VDC or 24VDC	—	<div>12VDC</div> <div>24VDC</div>	
4 Wire Leads Single voltage (Power input is polarity free)		✓	<div>12VDC</div> <div>24VDC</div>	Indicates the locked (N.O. contact) or unlocked (N.C. contact) status (Access Control Rating : 0.1A/20VDC (Resistive load))
5 Wire Leads Single voltage (Power input is polarity free)		✓	<div>12VDC</div> <div>24VDC</div>	Indicates the locked (N.O. contact) or unlocked (N.C. contact) status (Access Control Rating : 0.1A/20VDC (Resistive load))
4 Wire Leads Dual voltage (Power input is polarity free)	12VDC / 24VDC	—	<div>Parallel Connection:12VDC</div> <div>Series Connection:24VDC</div>	
6 Wire Leads Dual voltage (Power input is polarity free)		✓	<div>Parallel Connection:12VDC</div> <div>Series Connection:24VDC</div>	Indicates the locked (N.O. contact) or unlocked (N.C. contact) status (Access Control Rating : 0.1A/20VDC (Resistive load))
7 Wire Leads Dual voltage (Power input is polarity free)		✓	<div>Parallel Connection:12VDC</div> <div>Series Connection:24VDC</div>	Indicates the locked (N.O. contact) or unlocked (N.C. contact) status (Access Control Rating : 0.1A/20VDC (Resistive load))