

Backlight Series offers an LED for the ease of use in the dark.

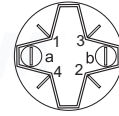

PBT-010L

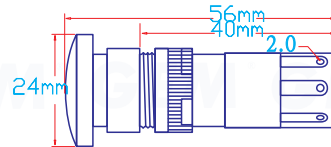
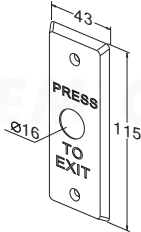

1,2=N/C  
3,4=N/O  
a=V0, b=V+



PBT-060BL

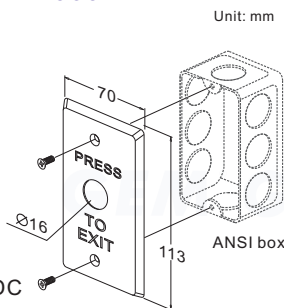

Unit: mm

Free Position

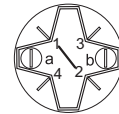
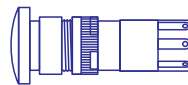

Operation Position

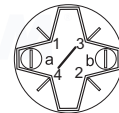
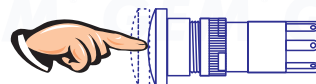

3.2mm Operating travel:  
3.2 mm

Materials(Button): PVC, Faceplate: stainless steel  
Type of actuation: Momentary  
Contact arrangement: DPDT  
Max. Rating : 5A/250 VAC, 6A/24VDC  
Current Draw: 25mA/12VDC  
Contact resistance: 50 mΩ Max.(initial)  
Operating life(Mechanical) : Over 100,000 cycles  
Operating travel: 3.2 mm



PBT-015

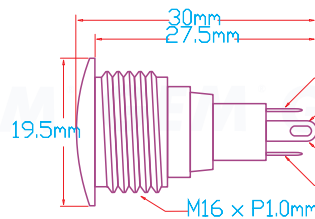
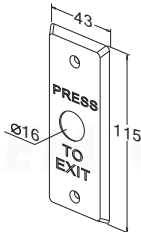

Blue=terminal  
Red=power input V+  
Black=power input V0  
Blue=terminal



PBT-015B

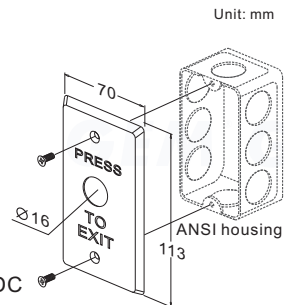

Unit: mm

Free Position

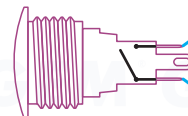

Blue=N/O output  
Blue=N/O output

Operation Position



Blue=N/C output  
Blue=N/C output

2.0mm Operating travel:  
2.0 mm

Materials(Button): Zinc alloy, Faceplate: stainless steel  
Type of actuation: Momentary  
Contact arrangement: DPDT  
Max. Ratings : 3A/125 VAC, 6A/24VDC  
Current Draw: 15mA/12VDC  
Contact resistance: 50 mΩ Max.(initial)  
Operating life(Mechanical) : Over 100,000 cycles  
Operating travel: 2 mm

### GIANNI INDUSTRIES, INC.



PBT-090-LED  
(surface mount)



PBT-100-LED  
(surface mount)



PBT-419DR-LED



PBT-419PTE-LED



PBT-020-LED



PBT-020B-LED



PBT-019B-LED

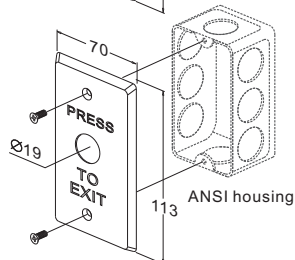
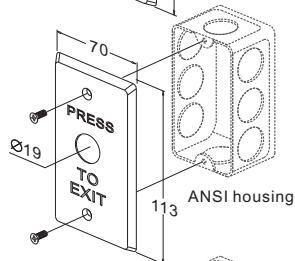
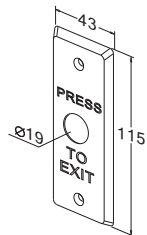
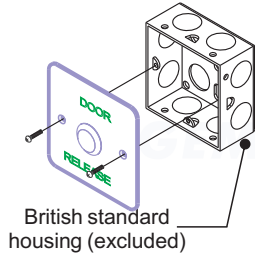
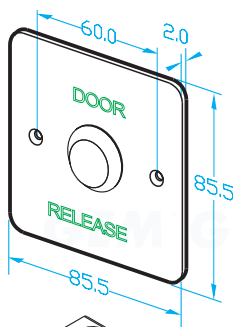
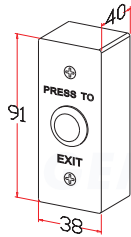
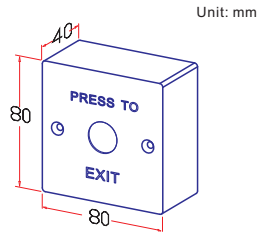

### ● Specification

- Faceplate material: Brushed Stainless Steel
- LED Operation Voltage: 9~30VDC
- Contact Arrangement: SPDT
- Contact Rating: 3A/30VDC/AC
- Contact Resistance: ≤50mΩ (initial)
- Operation Life: 5X10<sup>5</sup> cycles
- Mounting Diameter: 19mm
- Operating Travel: 1.5mm
- LED color: Blue / Green

### ● DIMENSIONS

Unit: mm

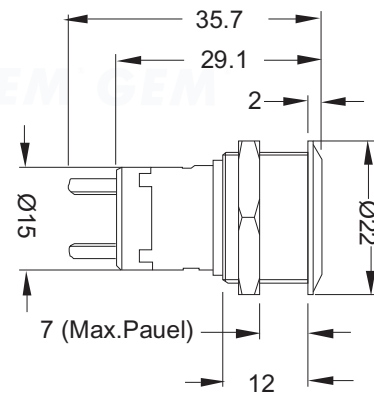
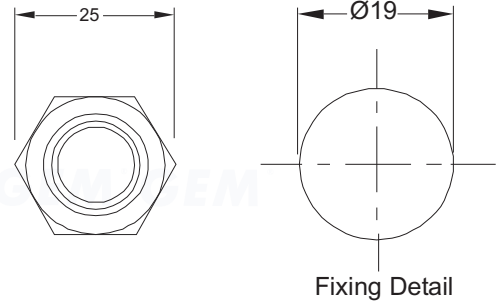

### ● Optional Accessory



SMB-050    SMB-040    SMB-86ALU

This series of request to exit buttons can be mounted directly in the hollow door frame (Mortise mount) or surface-mounted with SMB-050, SMB-040 and SMB-86ALU housings.

### GIANNI INDUSTRIES, INC.

No. 13, Zhongxing Rd., Tucheng Dist., New Taipei City 236, Taiwan (R.O.C.)  
 Tel: 886-2 2267 7986 / Fax: 886-2 2267 9876  
 E-Mail: inquiry@gianni.com.tw  
 Website: gianni.tw