

The A values in the table below indicate the minimal widths required for the installation of maglocks. An L-bracket is required for frames narrower than A values.

Magnet Grade	A Value	Optional Brackets
300 LBS	38mm	L-150, L-EM150...
600 LBS	42mm	L-300, L-N10001ST...
800LBS	48mm	L-750, L-350, L-400...
● 1200 LBS	60mm	L-500, L-600...

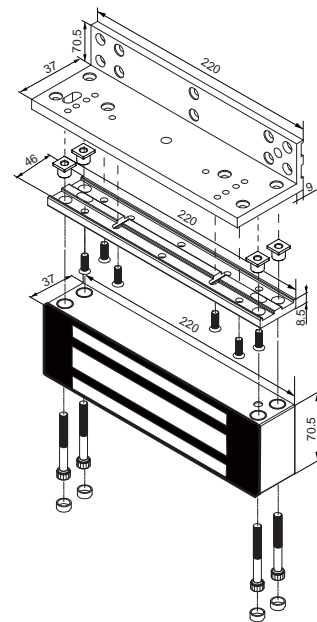

■ Application: N10010ST series of electromagnetic locks

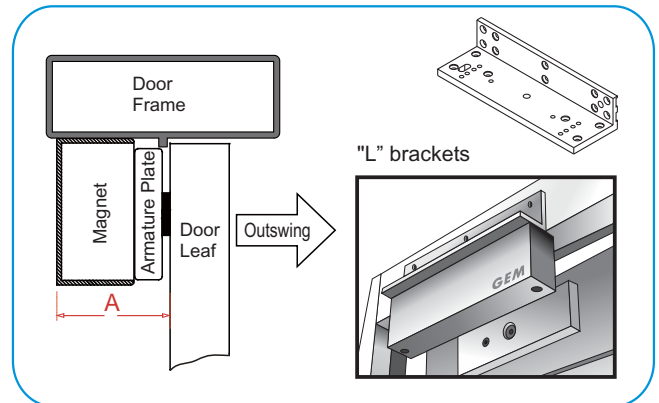

Unit: mm

With L bracket for outswing doors

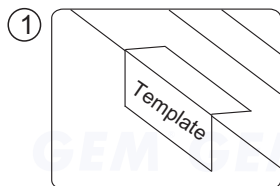

① Fold the mounting template 90°

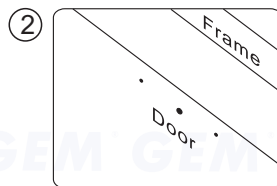

② Drill the holes marked in the template.

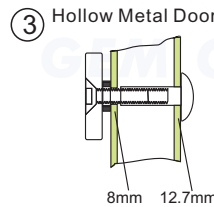

③ Hollow Metal Door
Drill a Ø 8 mm hole thru door, from sexnut bolt side enlarge to Ø 12.7mm.

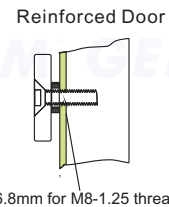

Reinforced Door
Drill a Ø 6.8 mm Hole and tap for M8x1.25 thread.

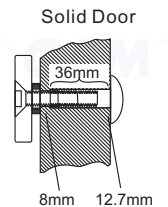

Solid Door
Drill a Ø 8 mm hole thru door from sexnut bolt side enlarge to 12.7 mm , 36mm in depth.

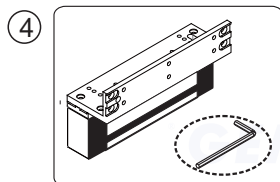

④ Fasten the maglock to the L-bracket with an allen wrench. Do not tighten them firmly.

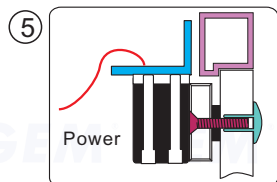

⑤ Connect to the power. Let the magnet attract the armature plate. Press the L-bracket on to the frame.

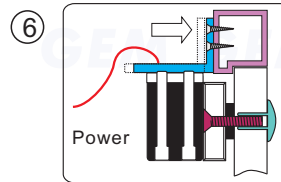

⑥ Once the position is correct , use the screws to permanently mount the L bracket on the door frame.

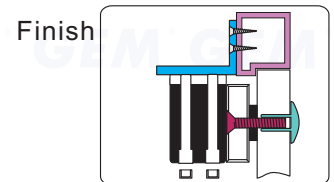

Finish
Test the unit . Insert the anti-tamper caps into the mounting screw access holes.

GIANNI INDUSTRIES, INC.