

Fire Exposure and Hose Stream Tests were conducted in accordance with the standard, "Positive Pressure Fire Tests of Door Assemblies," ANSI / UL 10B and 10C, uniform building code standard UBC 7-2 (1997).

Features

- High reliability
- Fail- safe (Power to Lock)
- Aluminum anodized casing
- MOV provides spike and surge protection
- Dual voltage 12 or 24 VDC (selectable)
- Anti-Residual magnetism function

Statement

GL-600S mini surface water-proof Electromagnetic Locks design with no mechanical parts but magnetic force to secure and release the doors, suitable for use in areas which required access controlled or egress such as exit door.

The Electromagnetic Locks are totally sealed in an epoxy filled stainless steel case for water-resistant and vandal-resistant purpose. A threaded conduit fitting ensures weather resistant protection of the wiring therefore it is ideal for indoor and outdoor applications, even in severe weather.

Specifications

- Operating Voltage: 12/24 VDC
- Current Draw: 500mA/12VDC , 250mA/24VDC (at temperature 20°C)
- Operating Temperature: -10~55°C (14~131°F)
- Humidity: 0~95% non-condensing.
- Holding Force: 600 lbs (272 Kg)
- Dimensions:
 - Magnet:(L) 203, (W) 43, (D) 40 mm
 - Armature Plate:(L) 159, (W) 41, (D) 14 mm
- Special Finishes for magnet and armature plate: Zinc plated
- Epoxy Potting Compound: E87252 (S), UL94V-0
- Net Weight: 2.0 Kg
- Bond sensor output (GL600R-S): 0.5A/20VDC

Regular Installation

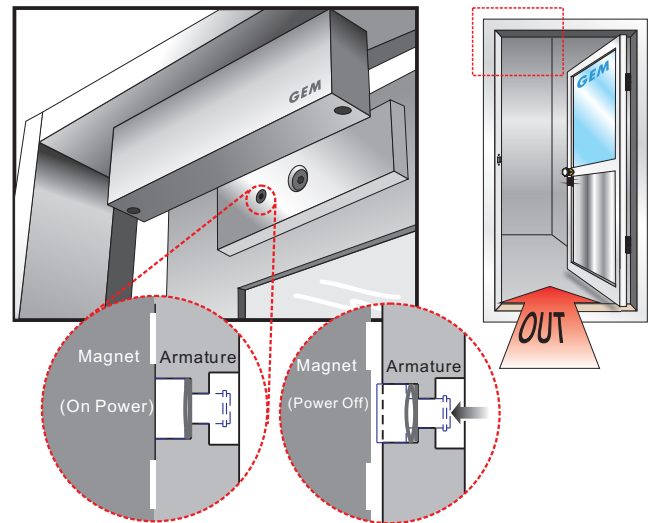

Anti-residual statement

Our electromagnet locks feature Anti-Residual Magnetism (ARM) which ensures the door can be opened without any resistance from left over magnetism imparted to the armature plate



This series of Waterproof Magnetic Lock is made with epoxy potting compound and is protected by this compound. Also, GEM Waterproof Series Magnetic Locks have been proved to have withstood a water resistance as established in accordance with the test procedures of IPX7, IPX8 through a trusted third party. Therefore users need not worry that the lock will be rusted or sparked, if the lock is using in outdoor applications and installing in confined space where any inflammable gas.

Warranty

The product is warranted against defects in material and workmanship while used in normal service for a period of 5 years from the date of sale to the original customer. The GEM policy is one of continual development and improvement; therefore GEM reserves the right to change specifications without notice.

GIANNI INDUSTRIES, INC.

No. 13, Zhong Sing Road, Tu-Cheng Industrial Zone,
Tu-Cheng City, Taipei, Taiwan 23678
Tel: 886-2 2267 7986 / Fax: 886-2 2267 9876
E-Mail: info@gianni.com.tw
Website: gianni.tw

Optional Brackets

Brackets installation are according to door swing direction and door frame type , e.g. narrow frame door , frameless glass door , inswing door , etc.

With L-bracket for narrow door frames

When "A" < 48 mm , must installed with "L" brackets.

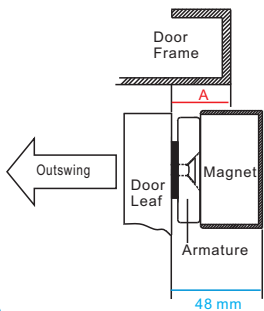

L-GL600

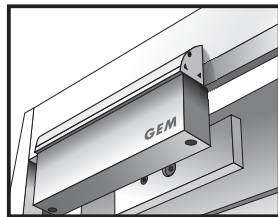
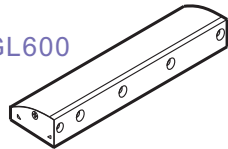

With LZ-bracket for inswing doors

LZ-GL600

