



● Features

- ✓ **AUX signal output:** In-built additional output for contact with other access control devices.
- ✓ **Allows up to 99 access PINs.**
- ✓ **3 LED indicators & buzzer for status indication.**
Keypad with beep sound.
- ✓ **Maximum 20-digit-code password anti-trailing design or lockout for 30 seconds after entering 5 times invalid PINs (The keypad without beep sound during the period time).**
- ✓ **Non-volatile memory due to power failure.**
- ✓ **Built-in tamper switch.**

● Specifications

- Operating Voltage: 12VAC/DC
- Current Draw : Average:50mA, Peak:130mA/12VDC
- Keypad: 4X3 matrix 12-digital (0~9,*,#)
- Input: 1 contact for Request-To-Exit button
- Output: 1 Relay (Dry Contacts: N.O./N.C./COM.)
- Relay Electric Current: Max.12A/14VDC
- LED indicator: 3 LEDs (Red & Yellow/Green/Yellow)
- Memory Volume : 99 PINs
- Relay Strike Time : 01~99 seconds or Toggle Mode(00)
- Ambient Humidity: 5~95%(Non-condensing)
- Operating Temperature: -20°C~70°C
- Invalid PIN Lock-Out : Maximum 20-digit-code password anti-trailing design or lockout for 30 seconds after entering 5 times invalid PINs (The keypad without beep sound during the period time).
- Optional PIN length:4~8 digit (master code & PINs must be same length)
- Net Weight: 178.6g
- Dimension: (H)114x(W)69.5x(T)35.5mm

● Warranty

The product is warranted against defects in material and workmanship while used in normal service for a period of 1 year from the date of sale to the original customer. The GEM policy is one of continual development and improvement; therefore GEM reserves the right to change specifications without notice.

● AUX Optional Operation

4 kinds of optional AUX output (preset only one kind)

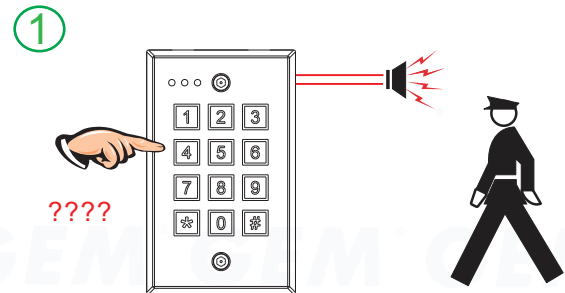

Personal Emergency: Press AUX PIN for selective output

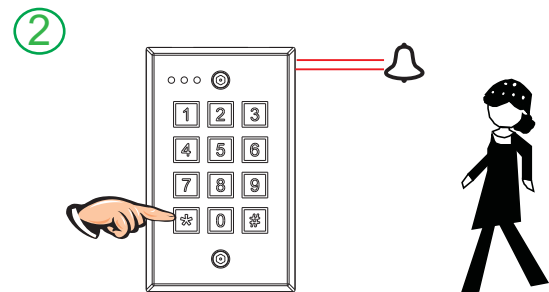

Door Bell: Press * key to output bell sound

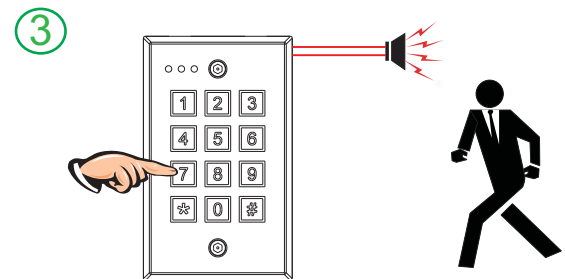

Alarm: Output alarm signal from invalid PINs

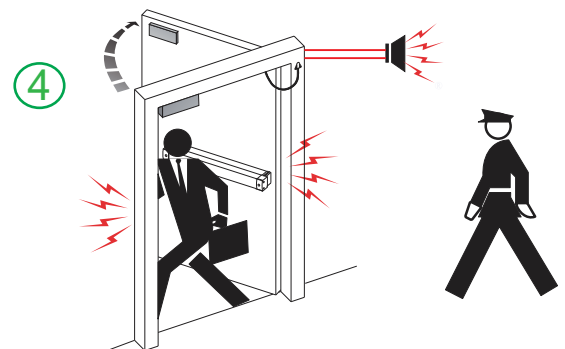

Exit Control: output signal from contact of exit button

GIANNI INDUSTRIES, INC.