

Electro-Mechanical Lock

ML-705M

Robust, Convenient & Electromechanical



The ML-705M electric lock is a high performance lock designed for single action swing doors. Featuring a double action latchbolt and left/right side adjustable deadlatch tip, the ML-705M allows deadlocking automatically when the door is closed to be secured for ease of use and convenience. The ML-705M can be controlled by card readers/keypads and connected to automatic swing door operators for an integrated access control solution.

Standard Features

- For single action swing doors (applicable to double action doors)
- For narrow frames
- Non-handed (Double action latchbolt and deadlatch direction auto changeable)
- Brushed stainless steel construction
- Fail-safe /Fail-secure reversible
- Lock monitor

Specifications

- Operating Voltage: 12~24VAC/DC
- Current Draw: 250mA/12VDC; 150mA/24VDC
- Lock Status Output: 3A/125VAC
- Endurance Rating: 250,000 cycles (Factory tested)
- Backset: 25 mm

Dimensions

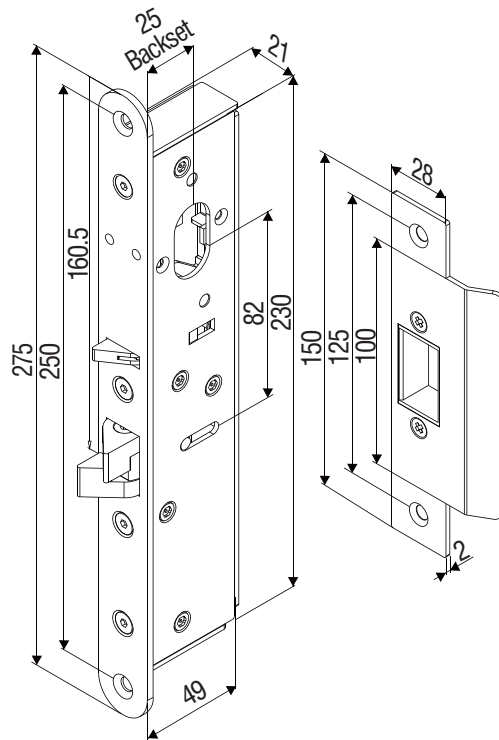

Unit: mm

Installation Diagram

Mortise mount (Single swing)

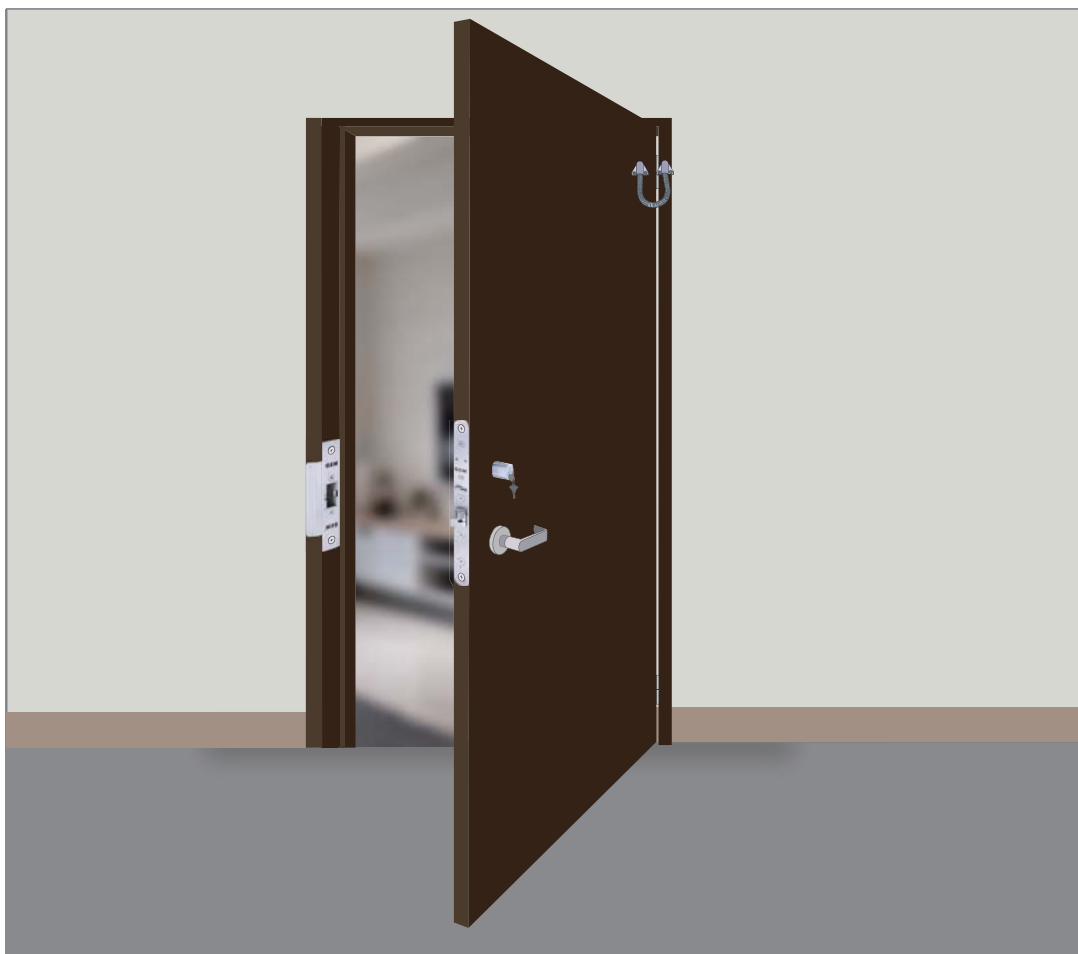

Warranty

The product is warranted against defects in material and workmanship while used in normal service for a period of 1 year from the date of sale to the original client. The GEM policy is one of continual development and improvement; therefore GEM reserves the right to change specifications without notice.