

Electric Strikes

GK1270/1290 Rim Strike Series Surface Mount Strikes for Pullman Latch Exit Devices



GK1270



GK1290

SECURITY



The GK1270/1290 ANSI electric rim strike series is surface mounted and designed with strength and durability for use with rim exit devices with a Pullman latch bolt. It features an optional latch monitor and has a stainless steel housing. No cutting on the frame is required for installation.

Standard Features

- Field selectable 12 or 24VDC
- Field reversible fail-secure or fail-safe
- No frame cutting required - surface mounted
- Non-handed fully reversible
- Horizontal adjustment
- Static strength 1,500 lbs (680Kg)
- Dynamic strength 70 ft-lbs
- Endurance rating 250,000 cycles UL tested, 1,000,000 cycles factory tested
- Brushed stainless steel finish (US32D)

Optional Feature

- Latch monitor

Patents, Approvals, and Listings

- UL 1034 burglary resistant listed: R10269

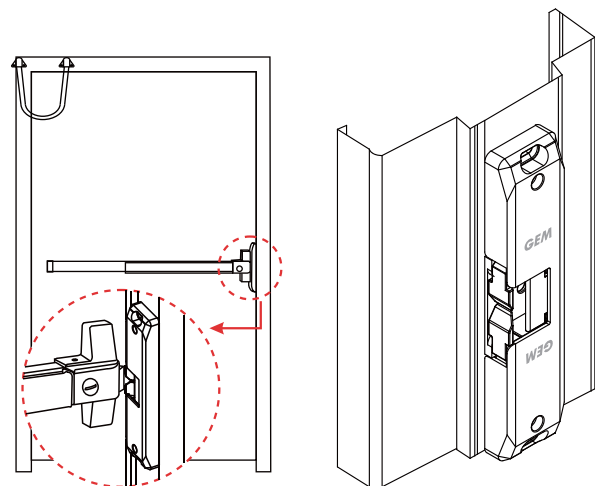

GK1270/1290 Series ANSI Electric Rim Strikes

Models	Voltage (VDC)	Latch Monitor	Housing Thickness	Field Reversible Fail-Safe Or Fail-Secure
GK1270 <small>SECURITY LISTED</small>	12/24	—	3/4" (19mm)	●
GK1270M <small>SECURITY LISTED</small>		●		
GK1290 <small>SECURITY LISTED</small>	12/24	—	1/2" (13mm)	●
GK1290M <small>SECURITY LISTED</small>		●		

Dimensions

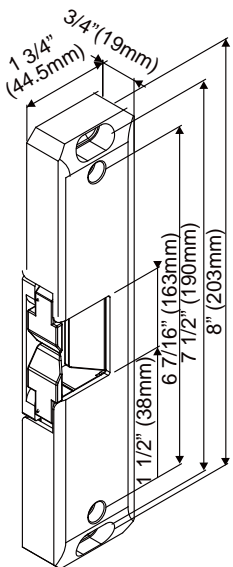

GK1270

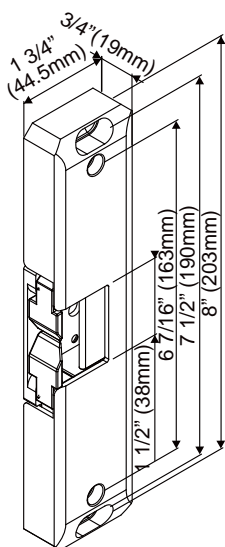

GK1270M

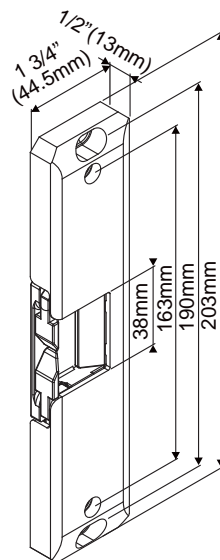

GK1290

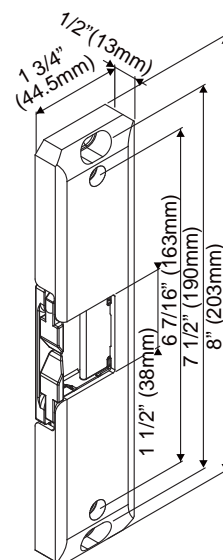

GK1290M

Changing Fail-Safe / Fail-Secure

Fail-safe or fail-secure is field reversible by changing the position of screws.

Fail-Safe

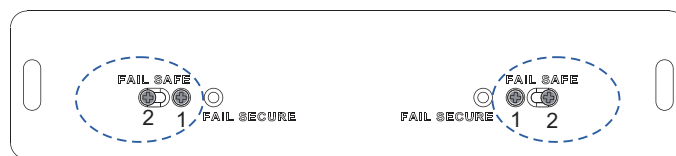

Fail-Secure

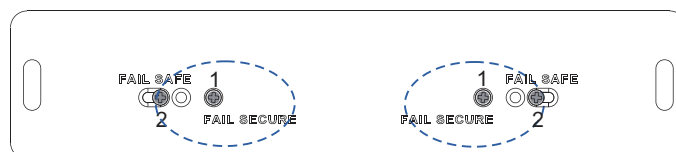

Warranty

The product is warranted against defects in material and workmanship while used in normal service for a period of 3 years from the date of sale to the original client. The GEM policy is one of continual development and improvement; therefore GEM reserves the right to change specifications without notice.